

REPLACEMENT

HINT:

There are 2 methods ((a) and (b)) to replace the oil seal.

REPLACE TIMING CHAIN COVER OIL SEAL

(a) If the rear timing chain cover is removed:

- (1) Using a screwdriver, pry out the oil seal.

NOTICE:

Be careful not to damage the oil pump. Wrap the tip of the screwdriver with tape.

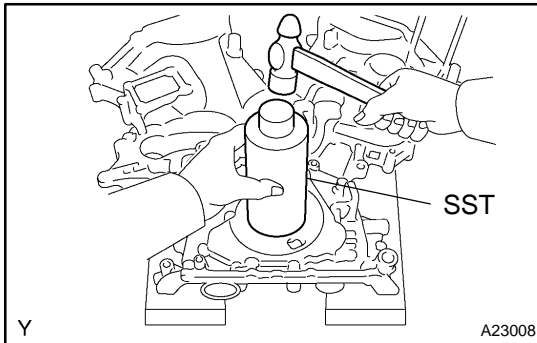

- (2) Using SST and a hammer, tap in a new oil seal until its surface is flush with the timing chain cover edge.

SST 09226-10010

- (3) Apply MP grease to the oil seal lip.

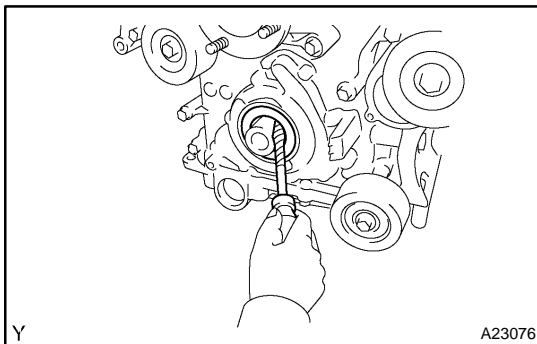

(b) If the rear timing chain cover is installed:

- (1) Using a screwdriver, pry out the oil seal.

NOTICE:

Be careful not to damage the crankshaft. Wrap the tip of the screwdriver with tape.

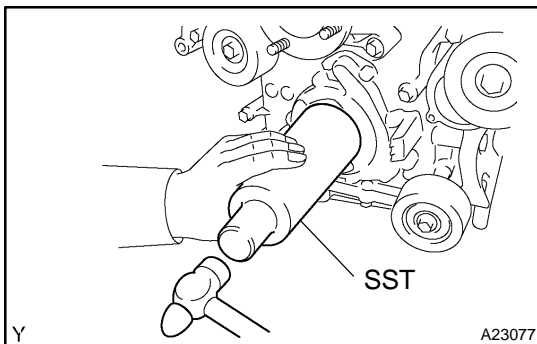

- (2) Using SST and a hammer, tap in the oil seal until its surface is flush with the timing chain cover edge.

SST 09226-10010

- (3) Apply MP grease to a new oil seal lip.